

OPTICAL MEASURING MACHINES

SYLVAC SCAN

Dedicated to fast, precise, non-contact measurement of cylindrical parts. Our new SCAN machines reproduce high resolution images of the components profile in just a few seconds. Thanks to the easy to use Reflex-SCAN software, parts can be measured with just a click of a button, offering over 150 different types of measurement features.

SYLVAC VISIO

Our 2.5D video measuring systems equipped with manual XY stage and manual/motorized optical zoom allow to quickly measure most of the industrial components based on the live image of the workpiece displayed on the software.

Our SCAN and VISIO machines are designed for use in the workshop or laboratory. Discover them without further delay !



Optical measurement

SYLVAC-SCAN

DESCRIPTION

52 REFLEX-CLICK

- Horizontal SCAN machine, measuring in landscape format, the same as the parts are produced
- Robust construction with granite column for use in workshop or control laboratory
- Concept Reflex SCAN patented for measuring cylindrical workpieces without preprogramming
- Measurements performed in seconds by a single click
- Load the part, click the button and you get all the main values directly!
- Automatic recognition of recorded parts already measured
- Easy daily calibration thanks to the integrated master
- Quick return of investment



Sylvac Reflex SCAN Software

One click measurement



For turned parts

Optical measurement

SYLVAC-SCAN

DIMENSIONAL DRAWINGS

52 REFLEX-CLICK

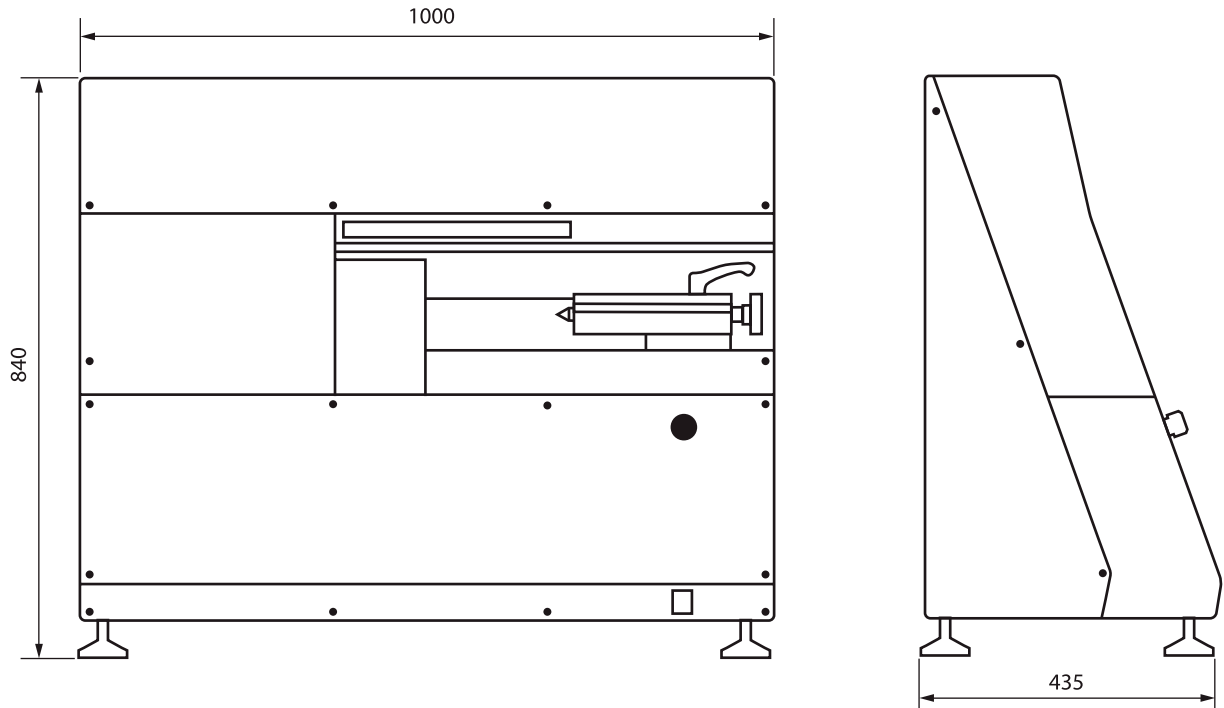

TECHNICAL SPECIFICATIONS

		902.5520		902.5521	
		Diameter	Length	Diameter	Length
Measuring range	mm	0.5 ÷ 52	300	0.5 ÷ 52	300
Resolution up to	mm	0.0001	0.0005	0.0001	0.0005
Max. error	µm	1.5 + D/100	4 + L/100	1.5 + D/100	4 + L/100
Repeatability	µm	0.6	2.5	0.6	2.5
Headstock		Non-Rotating headstock for static measurements		Rotary headstock for static and dynamic measurements	
Max. weighth of part	kg	4			
Machine's weight	kg	103			

STANDARD DELIVERY

- Instrument according to technical specifications
- Accessories : 2x 902.6202, 902.6161, 902.6212
- Computer with screen, keyboard and mouse
- Windows multilingual operating system
- Sylvac Reflex SCAN Software
- Manual

Optical measurement

SYLVAC-SCAN

DESCRIPTION

F60 & F60T

- Concept Reflex SCAN patented for measuring cylindrical workpieces without preprogramming
- Part measurement from **0.2 to 64mm diameter and up to 300mm** length
- Complete 2D part scan in <3 seconds !
- Reduce inspection time, scrap and increase productivity
- Exclusive helix tilting system for thread measurements (only on T models)
- Quick return of investment, typically < 6 months
- Software Reflex SCAN + : advanced programming and functions
- Quick release tooling



LED status light indicator

Software
Reflex SCAN +



Emergency
button

Start button

One click
measurement

Door for dust
protection

 **SWISS
MADE**



Exclusive helix tilting system by Sylvac, for more comprehensive thread measurements.

Optical measurement

SYLVAC-SCAN

DIMENSIONAL DRAWINGS

F60 & F60T

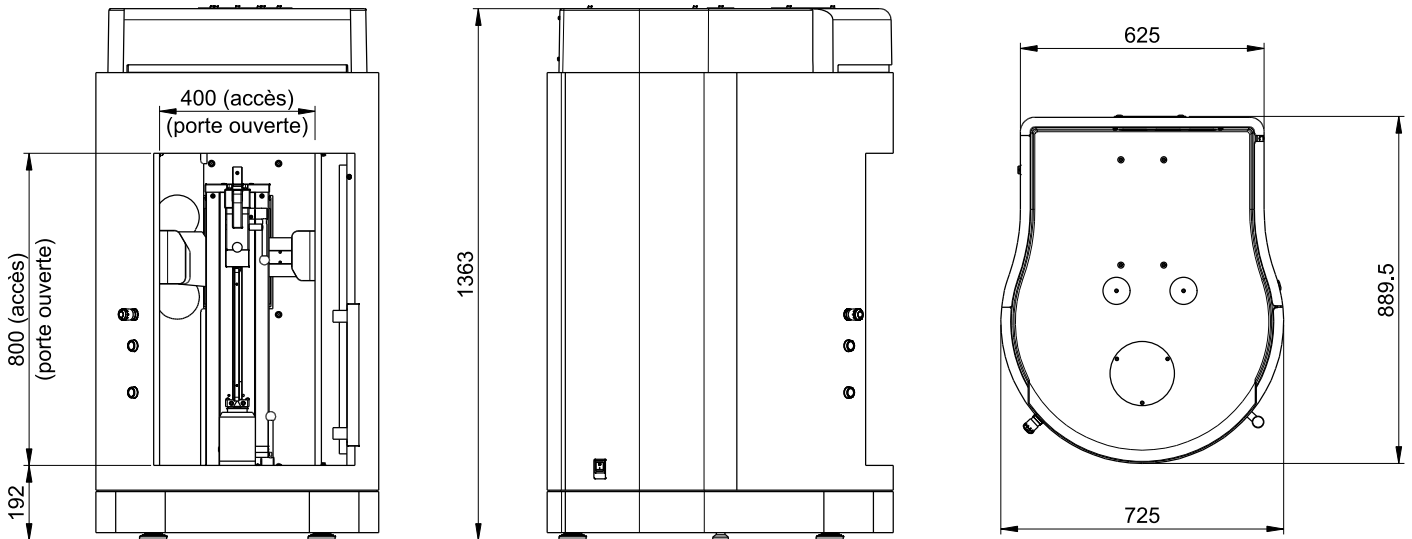

TECHNICAL SPECIFICATIONS

		902.4060		902.4065	
		Sylvac SCAN F60		Sylvac SCAN F60T	
		Diameter	Length	Diameter	Length
Measuring range	mm	64	300	64	300
Resolution up to	mm	0.0001	0.0001	0.0001	0.0001
Max. error	µm	(1 + D[mm]/100) µm	(3 + L[mm]/200) µm	(1 + D[mm]/100) µm	(3 + L[mm]/200) µm
Repeatability	µm	0.5	1.0	0.5	1.0
Holding capacity diameter	mm	120	315	120	315
Headstock		Rotary headstock for static and dynamic measurements			
Tilting for thread measurement		-		● 30°	
Max. weighth of part	kg	10			
Machine's weight	kg	265			

STANDARD DELIVERY

- Instrument according to technical specifications
- Accessories : 2x 902.6202, 902.6161, 902.6212
- Computer with screen, keyboard and mouse
- Windows multilingual operating system
- Sylvac Reflex SCAN Software +
- Manual

Optical measurement

SYLVAC-SCAN

DESCRIPTION

F60L & F60LT

- Concept Reflex SCAN patented for measuring cylindrical workpieces without preprogramming
- Part measurement from **0.2 to 64mm diameter and up to 500mm** length
- Complete 2D part scan (500mm) in <5 seconds !
- Reduce inspection time, scrap and increase productivity
- Exclusive helix tilting system for thread measurements (only on T models)
- Quick return of investment, typically < 6 months
- Software Reflex SCAN + : advanced programming and functions
- Quick release tooling

Version L !

LED status light indicator



Exclusive helix tilting system by Sylvac, for more comprehensive thread measurements.

Software Reflex SCAN +



One click measurement



Door for dust protection

Optical measurement

SYLVAC-SCAN

DIMENSIONAL DRAWINGS

F60L & F60LT

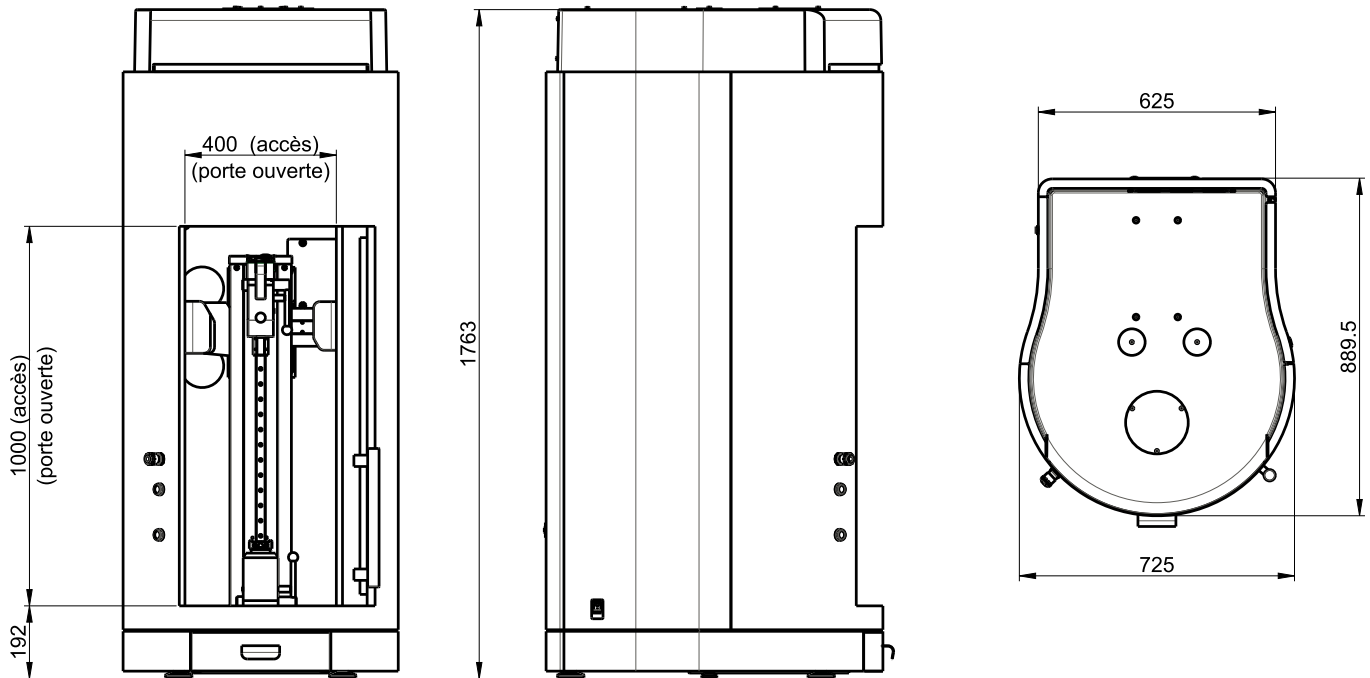

TECHNICAL SPECIFICATIONS

		902.4062		902.4067	
		Sylvac SCAN F60L		Sylvac SCAN F60LT	
		Diameter	Length	Diameter	Length
Measuring range	mm	64	500	64	500
Resolution up to	mm	0.0001	0.0001	0.0001	0.0001
Max. error	µm	(1 + D[mm]/100) µm	(3 + L[mm]/200) µm	(1 + D[mm]/100) µm	(3 + L[mm]/200) µm
Repeatability	µm	0.5	1.0	0.5	1.0
Holding capacity diameter	mm	120	500	120	500
Headstock		Rotary headstock for static and dynamic measurements			
Tilting for thread measurement		-		● 30°	
Max. weigth of part	kg	10			
Machine's weight	kg	330			

STANDARD DELIVERY

- Instrument according to technical specifications
- Accessories : 2x 902.6202, 902.6161, 902.6212
- Computer with screen, keyboard and mouse

- Windows multilingual operating system
- Sylvac Reflex SCAN Software +
- Manual

Optical measurement

SYLVAC-SCAN

DESCRIPTION

S145

- Concept Reflex SCAN patented for measuring cylindrical workpieces without preprogramming
- Part measurement from **0.2 to 145mm diameter and up to 615mm** length
- Complete 2D part scan
- Reduce inspection time, scrap and increase productivity
- Quick return of investment
- Software Reflex SCAN + : advanced programming and functions
- Quick release tooling

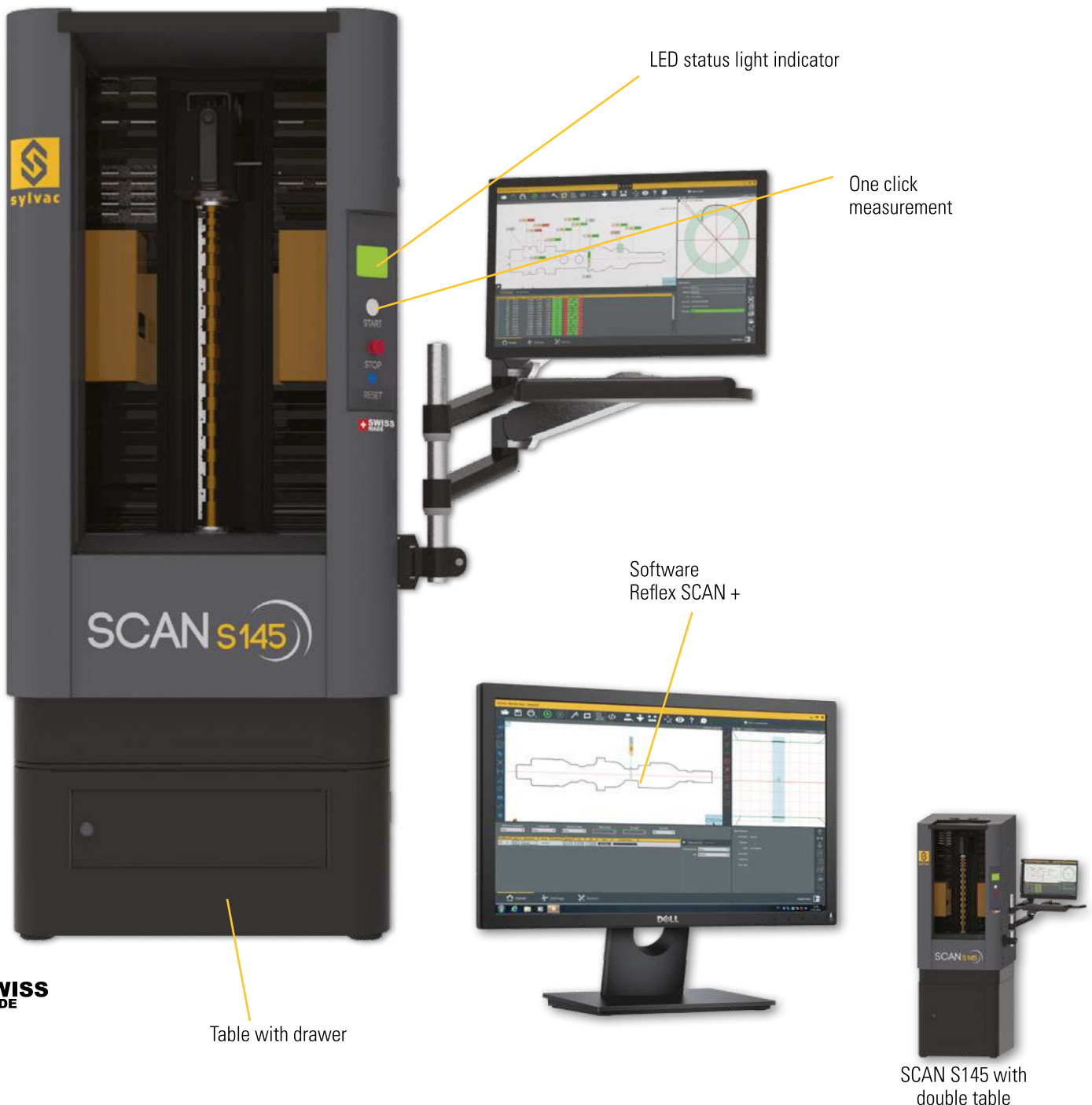

Optical measurement

SYLVAC-SCAN

DIMENSIONAL DRAWINGS

S145

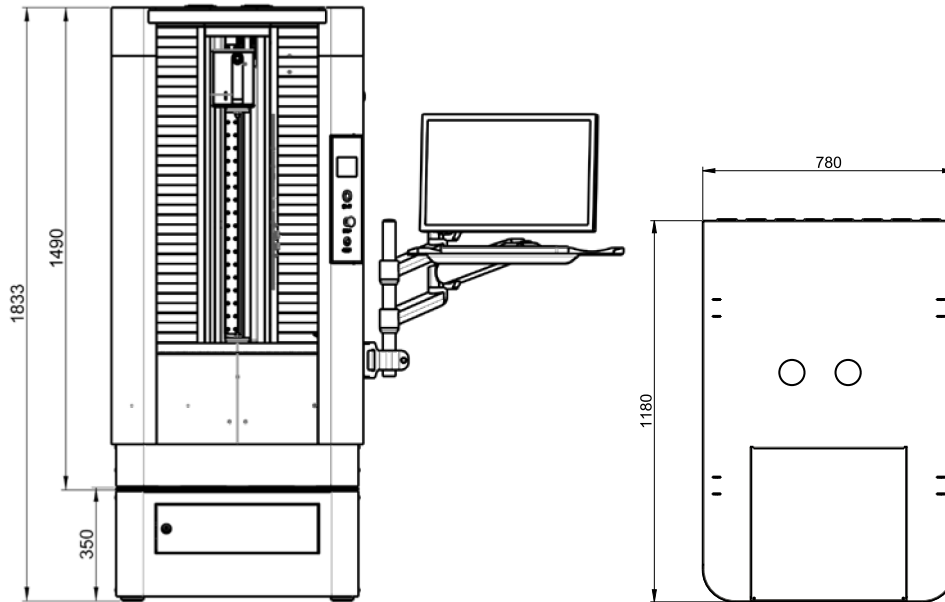

TECHNICAL SPECIFICATIONS

		902.4145	
		Sylvac SCAN S145	
		Diameter	Length
Measuring range	mm	145	615
Resolution up to	mm	0.0001	0.0001
Max. error	µm	$(1.5 + D[\text{mm}]/100) \mu\text{m}$	$(4 + L[\text{mm}]/200) \mu\text{m}$
Repeatability	µm	$2\sigma=0.5$	$2\sigma=1.0$
Holding capacity diameter	mm	254	615
Rotation resolution	°	0.0003	
Axial measuring speed	mm/s	80	
Axial positioning speed	mm/s	Up to 200	
Rotational meas. speed	°/s	360	
Headstock		Rotary headstock for static and dynamic measurements	
Max. weight of part	kg	60	
Machine's weight	kg	530	

STANDARD DELIVERY

- Instrument according to technical specifications
- Adapter for Morse 2 (902.6260)
- Computer with screen, keyboard and mouse
- Windows multilingual operating system
- Sylvac Reflex SCAN Software +
- Manual

Optical measurement

SYLVAC-SCAN

DESCRIPTION

S145L

- Concept Reflex SCAN patented for measuring cylindrical workpieces without preprogramming
- Part measurement from **0.2 to 145mm diameter and up to 1280mm** length
- Complete 2D part scan
- Reduce inspection time, scrap and increase productivity
- Quick return of investment
- Software Reflex SCAN + : advanced programming and functions
- Quick release tooling

Version L !



Optical measurement

SYLVAC-SCAN

DIMENSIONAL DRAWINGS

S145L

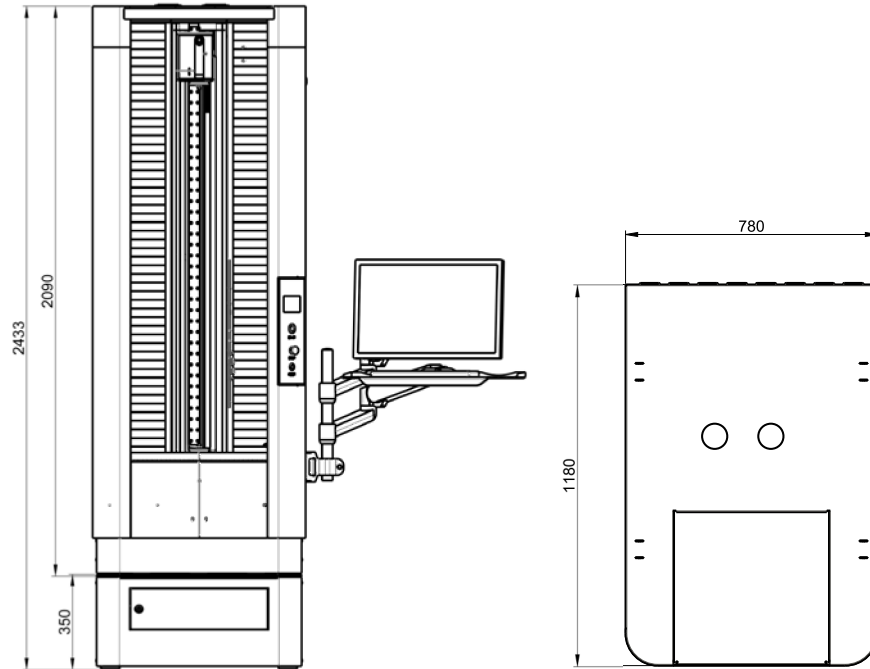

TECHNICAL SPECIFICATIONS

		902.4147	
		Sylvac SCAN S145	
		Diameter	Length
Measuring range	mm	145	1280
Resolution up to	mm	0.0001	0.0001
Max. error	µm	$(1.5 + D[\text{mm}]/100) \mu\text{m}$	$(4 + L[\text{mm}]/200) \mu\text{m}$
Repeatability	µm	$2\sigma=0.5$	$2\sigma=1.0$
Holding capacity diameter	mm	254	1280
Rotation resolution	°	0.0003	
Axial measuring speed	mm/s	80	
Axial positioning speed	mm/s	Up to 200	
Rotational meas. speed	°/s	360	
Headstock		Rotary headstock for static and dynamic measurements	
Max. weight of part	kg	60	
Machine's weight	kg	650	

STANDARD DELIVERY

- Instrument according to technical specifications
- Adapter for Morse 2 (902.6260)
- Computer with screen, keyboard and mouse
- Windows multilingual operating system
- Sylvac Reflex SCAN Software +
- Manual

J

Optical measurement

SYLVAC-SCAN

TECHNICAL SPECIFICATIONS

SOFTWARES

	FUNCTIONS	
	SYLVAC REFLEX SCAN	SYLVAC REFLEX SCAN+
Automatic measurement of the main features (diameters, lengths, angles, radius)	•	•
Automatic parts / program recognition	•	•
Off-line programming		•
Advanced dust filtering		•
Statistic view		•
CAD import		•
Reports editor	•	•
Data export	•	•
SPC basic calculations	•	•
Script function		option
SPC software	on request	on request
Access management - security lever	1	multiple

	GEOMETRICAL TOLERANCING - FEATURES SUMMARY	
	SYLVAC REFLEX SCAN	SYLVAC REFLEX SCAN+
Diameters	•	•
Lengths, heights, distances	•	•
Angles, chamfers	•	•
Radii	•	•
Threads (parallel)	•	•
Advanced threads measurement (root detail, taper, multistarts, ball screws, worm screws, special threads)		•
Perpendicularity		•
Form deviation		•
Rotational diameters	basic	advanced
Run out	basic	advanced
Concentricity	basic	advanced
Roundness	•	•
Cylindricity	•	•
Across flats	•	•
Straightness		•
Interrupted parts (splines, turbines)		•

Optical measurement

SYLVAC-SCAN

ACCESSORIES

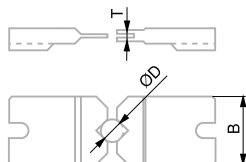
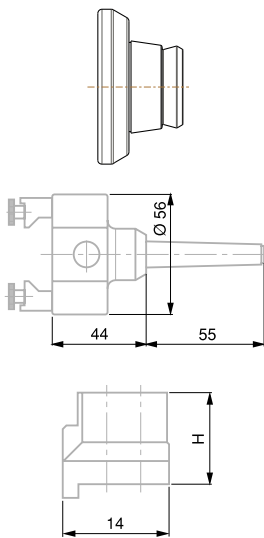

		Morse 2 SCAN 52 / F60	Scan S145
902.6260	Adapter MK2 for SCAN S145		•
902.6220	Two-jaw gripper External clamping for manual use	• Requires 902.6360	• Requires 902.6260
902.6231 H=22	Raising blocks for external jaws, in pairs	• (Morse 1 requires 902.6220)	• Requires 902.6260
902.6228	Magnetic clamping plate Ø0-24 mm	•	• Requires 902.6260
902.6141 0÷6 mm T=1.5	External jaws, in pairs	• For 902.6220 (also for Morse 1)	•
902.6142 0÷6 mm T=3			
902.6143 6÷12 mm T=3			
902.6144 12÷18 mm T=6			
902.6145 18÷24 mm T=9			
902.6152 0÷6 mm T=6			
902.6153 0÷6 mm T=15			
902.6140 6÷12 mm T=15			

Optical measurement

SYLVAC-SCAN

ACCESSORIES

Morse 2
SCAN 52 / F60

Scan S145

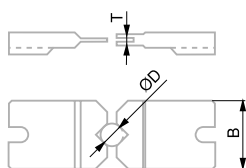

902.6154

Set with:
902.6141
902.6142
902.6143
902.6144
902.6145

External jaws,
in pairs

902.6141 : Jaws dia 0-6mm, T1=1.5mm
902.6142 : Jaws dia 0-6mm, T1=1.3mm
902.6143 : Jaws dia 6-12mm, T1=3mm
902.6144 : Jaws dia 12-18mm, T1=6mm
902.6145 : Jaws dia 18-24mm, T1=9mm

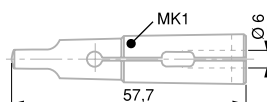

902.6250

Center
adapter with
a 6 mm dia.
coupling bore

Only for Morse 1

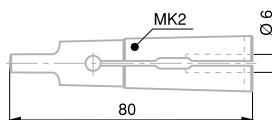

902.6251

Center adapter
with a 6 mm dia.
coupling bore

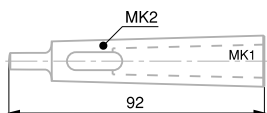

902.6360

Reduction
sleeve,
Morse 2 to 1

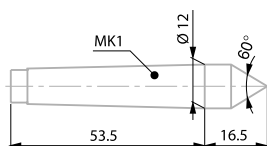

902.6000

Extra male center, 10 mm
(2 items provided with
SYLVAC-SCAN 25)

Only for Morse 1

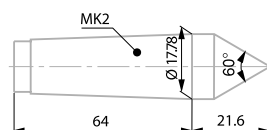

902.6202

Extra male center, 17.78 mm
(2 items provided with SYLVAC-SCAN F60 and
SYLVAC-SCAN 52 Reflex-Click)

Standard

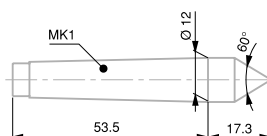

902.6203

Drive centre
(Diamond coated 10 mm)

Only for Morse 1

Optical measurement

SYLVAC-SCAN

ACCESSORIES

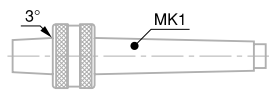

902.6160

Rotation center with a B12 male taper plus
a Morse 1 taper shank
(For added sleeves 902.6206/902.6207)

Morse 2
SCAN 52 / F60
Only for Morse 1

Scan S145

•
Requires
902.6260

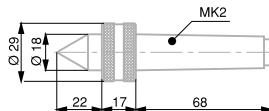

902.6161

Rotation center,
Morse 2
(1 item provided with SYLVAC-SCAN F60 and
SYLVAC-SCAN 52 Reflex-Click)

•
Standard

•
Requires
902.6260

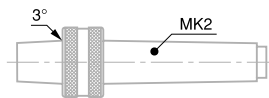

902.6162

Rotation center
with a B18
male taper plus
a Morse 2 shank

•

•
Requires
902.6260

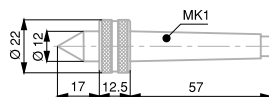

902.6163

Rotation center,
Morse 1

Only for Morse 1

•
Requires
902.6260

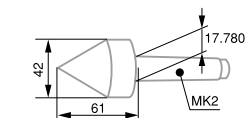

902.6380

Rotation center,
Morse 2

•

•
Requires
902.6260

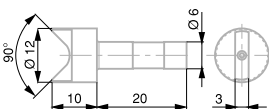

902.6204

Female center,
10 mm dia.

•
Requires
902.6251
(also for Morse 1, with
902.6250)

•
Requires
902.6260

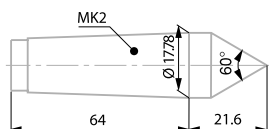

902.6212

Extra male center, 17.78 mm, diamond coated
(1 item provided with SYLVAC-SCAN F60 and
SYLVAC-SCAN 52 Reflex-Click)

•
Standard

•
Requires
902.6260

Optical measurement

SYLVAC-SCAN

ACCESSORIES

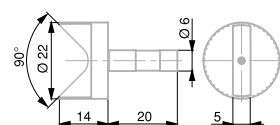

902.6205

Female center,
20 mm dia.

**Morse 2
SCAN 52 / F60**

•
Requires
902.6251
(Morse 1 requires
902.6250)

Scan S145

•
Requires
902.6260

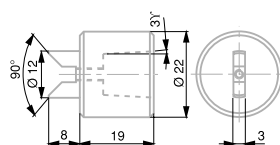

902.6206

Female center,
10 mm dia.
Also with internal
B12 taper

Only for Morse 1
(requires 902.6160)

•
Requires
902.6260

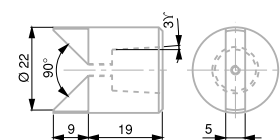

902.6207

Female center,
12 mm dia.
Also with internal
B12 taper

Only for Morse 1
(requires 902.6160)

•
Requires
902.6260

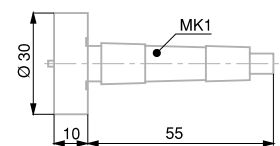

902.6208

Platten,
30 mm dia.

Only for Morse 1

•
Requires
902.6260

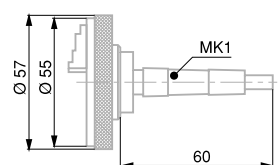

902.6300

3-jaw chuck, clamping range 1÷15 mm
(Clamping capacity: outside 1÷15 mm
inside 11÷26 mm)

•
Requires
902.6360
(also for Morse 1)

•
Requires
902.6260

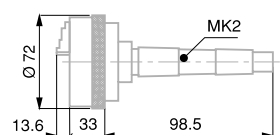

902.6301

3-jaw chuck with Morse 2
taper shank, clamping range 2÷50 mm
(Clamping capacity: outside 2÷50 mm
inside 23÷50 mm)

•

•
Requires
902.6260

Optical measurement

SYLVAC-SCAN

ACCESSORIES

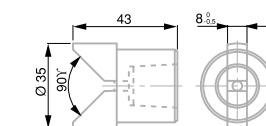
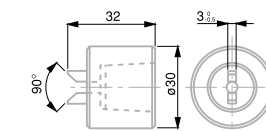
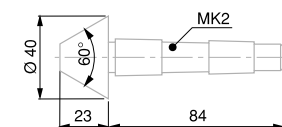
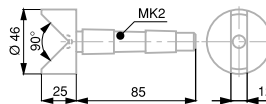
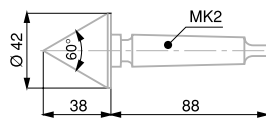
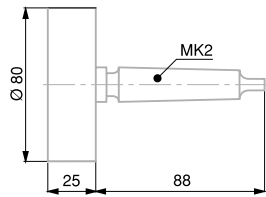

		Morse 2 SCAN 52 / F60	Scan S145
902.6209	Platten, 80 mm dia. with a Morse 2 taper shank	•	• Requires 902.6260
902.6210	Drive centre, Ø 40 mm. Diamond coated with a Morse 2 taper shank	•	• Requires 902.6260
902.6340	Female centre, 40 mm dia. with a Morse 2 taper shank	•	• Requires 902.6260
902.6341	Male centre, 15÷40 mm dia. with a Morse 2 taper shank	• Requires 902.6162	• Requires 902.6260
902.6310	Female center, 10 mm dia., with a B18 internal taper	• Requires 902.6162	• Requires 902.6260
902.6311	Female center, 30 mm dia., with a B18 internal taper	• Requires 902.6162	• Requires 902.6260

Optical measurement

SYLVAC-SCAN

ACCESSORIES

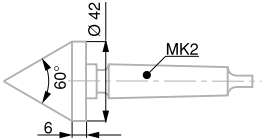
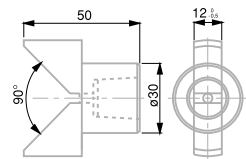

		Morse 2 SCAN 52 / F60	Scan S145
902.6312	Female center, 45 mm dia., with a B18 internal taper	• Requires 902.6162	• Requires 902.6260
902.6410	Drive centre - diamond coated, 42 mm dia. max.	•	• Requires 902.6260
902.6608	Option I/O for robotisation	•	• Requires 902.6260

Optical measurement

SYLVAC-SCAN

ACCESSORIES

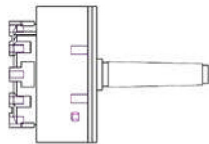
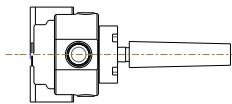

		Morse 2 SCAN 52 / F60	Scan S145
902.6270	2 jaw chuck Ø 0-18mm	•	• Requires 902.6260
902.6302	Pneumatic 4 jaw chuck Ø 1-63mm	•	• Requires 902.6260









Our Sylvac Scan range can be fully automated with a robot that can load all your workpieces for you directly on the machine for measurement. Available on request.

Optical measurement

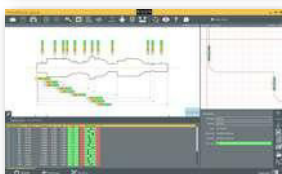
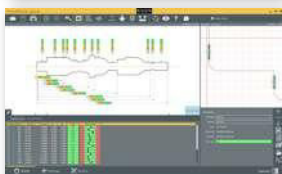
SYLVAC-SCAN

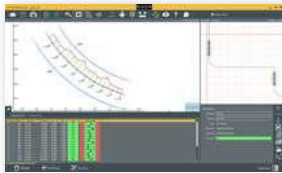
ACCESSORIES

			SCAN 52	SCAN F60	SCAN S145
	***	Reflex SCAN Standard (delivered with 902.5520 & 902.5521)	•		
	***	Reflex SCAN+ Standard (delivered with 902.4060, 902.4062, 902.4065 & 902.4067)		•	•
	902.7015	Reflex SCAN+ Offline Software		•	•
	902.7016	Reflex SCAN+ Script programming		•	•
	902.7017	Reflex-SCAN+ Automation software module (Option, require Reflex SCAN+)		•	•
	902.7018	Reflex-SCAN+ CAD compare software (Option, require Reflex SCAN+)		•	•
	902.7020	Reflex-SCAN+ Offline CAD compare software (Option, require Reflex SCAN+)		•	•
	902.7021	Reflex-Scan+ "PRO" With advanced feature wizards to build custom features and threads		•	•

Optical measurement

SYLVAC-SCAN

ACCESSORIES

			SCAN 52	SCAN F60	SCAN S145
	902.6012	Gold demo part	•	•	•
	902.6013	Gold demo part for threads	•	•	•
	902.6014	Gold demo part XL			•
	902.6600	Table for Sylvac SCAN F60 (85x85x70cm)		•	
	902.6601	Furniture for Sylvac SCAN F60 storage for PC, drawer with lock and arm for keyboard and screen		• Not for L versions	
	902.6605	Height-adjustable table (71-1140mm) for keyboard, screen and mouse (80x60mm)		•	
	902.6607	Accessories tidy insert for drawer (combined with 902.6601)		•	
	928.6006	Plastiform case for SCAN and VISIO	•	•	•
	902.6609	Rack	•	•	•

Optical measurement

SYLVAC-VISIO

DESCRIPTION

200 & 300 V3

- High quality 2.5D video measuring system with larger field of view up to 30x19mm (standard config 15x9.5mm)
- New software layout with auto toggle screens live/schematic and touch compatible
- Full HD Camera with improved image quality
- Robust construction with stage mounted on granite base and vertical column in granite
- Manual table stage releasable for quick XY movement, fitted with high precision encoders
- High quality bearing guidance for better accuracy
- Optics including CMOS camera and Navitar zoom (manual or motorised)
- Programmable triple lighting: coaxial, ring light programmable by sector and diascope light
- Multilingual Sylvac-REFLEX Vista software easy to use



Optical measurement

SYLVAC-VISIO

DIMENSIONAL DRAWINGS

200 & 300 V3

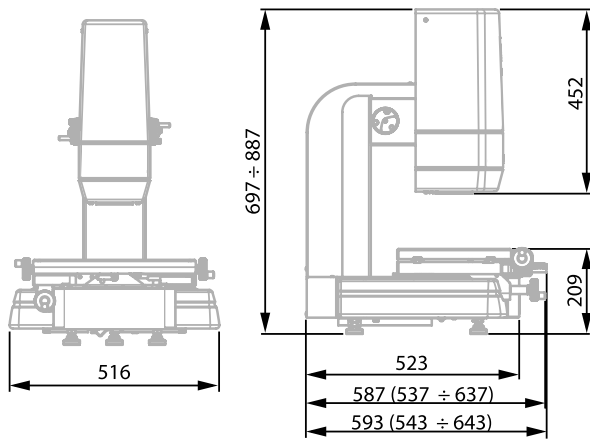

Sylvac VISIO 200 V3

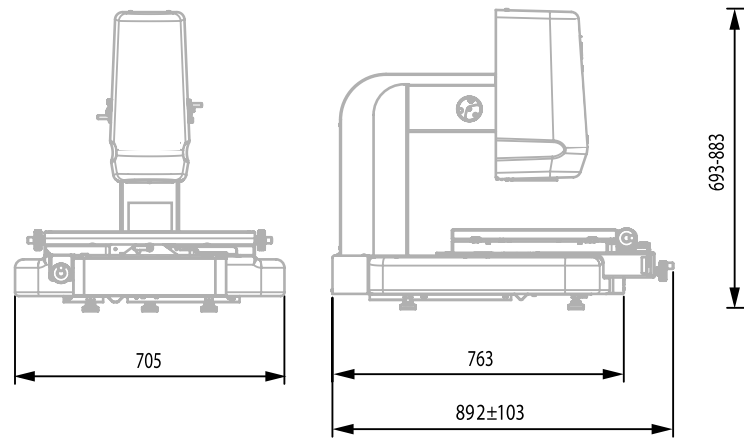

Sylvac VISIO 300 V3

TECHNICAL SPECIFICATIONS

		902.2210	902.2211	902.2310
Model		Sylvac Visio 200		Sylvac Visio 300
Measuring volume	mm	200x100x150		300x200x150
X, Y Accuracy (E_1 , X, Y)	μm	$1.9 + 10L/1000$ (L = mm) ¹⁾ / ³⁾		$1.9 + 4L/1000$ (L = mm) ¹⁾ / ³⁾
XY Accuracy (E_2 , XY)	μm	$2.4 + 10L/1000$ (L = mm) ¹⁾ / ³⁾		$2.4 + 4L/1000$ (L = mm) ¹⁾ / ³⁾
Z Accuracy (E_1 , Z) ²⁾	μm	$2.9 + 10L/1000$ (L = mm)		$2.9 + 5L/1000$ (L = mm)
Resolution	mm	0.001		0.001
Max. load capacity	kg	10		20
Magnification (screen 23.8")		24x - 144x (12x - 288x with additional lenses)		
Zoom		Manuel 4x	Motorised 6x	Motorised 6x
Weight		98		170
International standards		EN61000-6-2, EN61000-6-4, EN61326-1, EN12100-1, EN12100-2		

¹⁾ m ≤ 5 kg

²⁾ mechanical accuracy

³⁾ at glass plate level

STANDARD DELIVERY

- Instrument according to technical specifications
- Software Sylvac-REFLEX Vista multilingual
- Computer with touchscreen 23.8", keyboard and mouse
- CAD compare software
- Windows 10 multilingual operating system
- Manual
- Calibration certificate

Optical measurement

SYLVAC-VISIO

ACCESSORIES



902.6020

Visio demo part

VISIO 200

•

VISIO 300

•



902.7370

Diascopic illumination, parallel light

•

•

902.7100

Additional lens, 0,5x for zoom 6,5x

•

•

902.7101

Additional lens, 0,75x for zoom 6,5x

•

•

902.7102

Additional lens, 1.5x for zoom 6,5x

•

•

902.7103

Additional lens, 2x for zoom 6,5x

•

•



902.7380

Foot switch for value capture

•

•



902.7390

Sylvac - Reflex Vista COMPARE

Standard
delivery

Standard
delivery



928.6006

Plastiform case for SCAN and VISIO

•

•

Optical measurement

SYLVAC-VISIO

ACCESSORIES

			VISIO 200	VISIO 300
	902.7300	<p>Basic fixtures Kit :</p> <ul style="list-style-type: none"> 1x Quick-Load Corner Fixture (QLC) 1x 13mm x 150mm x 150mm R&R Acrylic Multi-Hole Fixture Plate 1x (3) Dowel Pins 3x 6mm Dia. x 10 and x 25mm Standoff 3x 9mm Dia. x 5, x 10, x 20 and x 25mm Standoff 3x 12mm Dia. x 10 and x 25mm Standoff 2x 6mm Dia. x 10mm Pin Standoff 2x 9mm Dia. x 10mm Pin Standoff 2x 40mm Tension Clamp with Rubber Coated Tip 2x 25mm Wire Clamp with Rubber Coated Tip 2x 50mm Wire Clamp with Rubber Coated Tip 4x Aluminium Resting Pin with M4 Thread 1x 50mm x 50mm Corner Viewer for M4 1x 9mm Dia. Adjustable Jackstand with M4 Thread 1x M4 Pusher Clamp 1x 30mm and 1x 45mm Long Adjustable Slide with M4 Thread 1x M4 Tower Block 1x Micro-Clamp Vise with Base for M4 Components 1x 12mm Dia. x10mm Spring Pusher Standoff Clamp 1x 300mm x 190mm x 25mm Component Tray to Hold M4 Components 	•	•
	902.7301	<p>Advanced fixtures Kit :</p> <p>All Basic fixtures (acrylic plate 13x200x200mm) kit added with :</p> <ul style="list-style-type: none"> 3x 6mm Dia. x 5, x 10 and x 25mm Standoff 3x 9mm Dia. x 10, x 20, x 25mm Standoff 3x 12mm Dia. x 10, x25mm Standoff 2x 6mm Dia. x 10mm Pin Standoff 2x 9mm Dia. x 10mm Pin Standoff 4x 12mm Dia. x 10mm Pin Standoff 2x 40mm Tension Clamp with Rubber Coated Tip 2x 25mm Wire Clamp with Rubber Coated Tip 2x 50mm Wire Clamp with Rubber Coated Tip with 50mm Post 1x 9mm Dia. Adjustable Jackstand with M4 Thread 1x 30mm and 1x 45mm Long Adjustable Slide with M4 Thread 1x Base 16mm Sq x 19mm (for M4 Tower Block) 	•	•
	902.7104	<p>Fresnel kit 0.5x</p> <p>Fresnel lens + lens 0.5x + fixation screws (for Ringlight)</p>	•	
	902.7105	<p>Fresnel kit 0.75x</p> <p>Fresnel lens + lens 0.75x + fixation screws (for Ringlight)</p>	•	
	902.7106	<p>Fresnel kit 1.5x</p> <p>Fresnel lens + lens 1.5x + fixation screws (for Ringlight)</p>	•	

Optical measurement

APPLICATIONS



Measurement of a turned part with SCAN 52

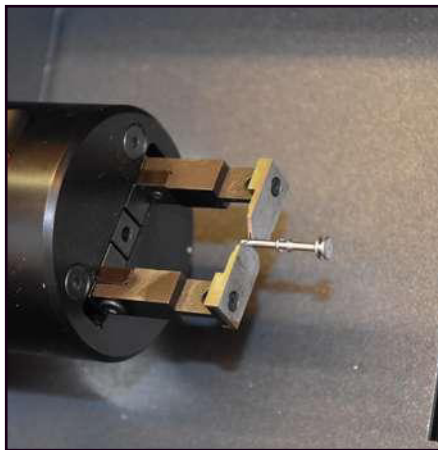

Small turning part held with 2-jaws gripper accessory on SCAN 52

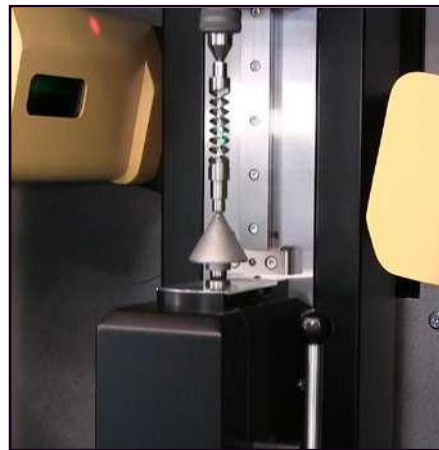

Thread measurement with SCAN F60T



Part measurement with SCAN F60



Part measurement with SCAN F60L



SCAN 52 and robot : closed loop with automatic correction of the part

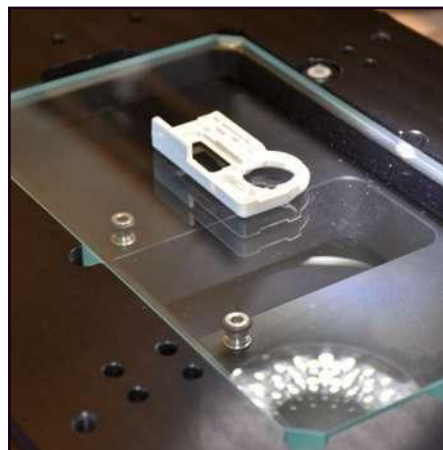

Part lighted by ring light on VISIO

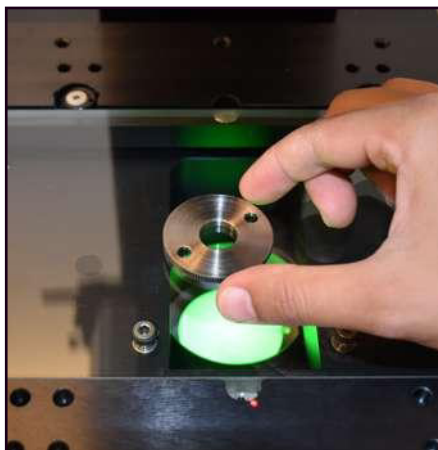

Part lighted by diascope light on VISIO

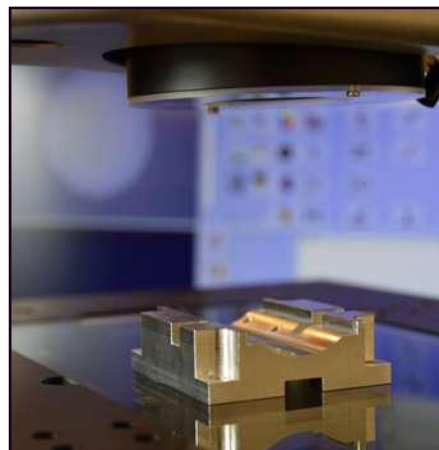

Part lighted by coaxial light on VISIO